

PLAN DATED	DRAWN BY	CHECKED BY
02.08.2022	KT/DB	GN
FILE REF	CAD REF	SCALE
ET208	TE46315U	A3 : 1/1500
SURVEYED ON	REVISION	
28.12.2021	...	

REVISED	Rev.	Int.	Date
AS PER OFFICERS PLAN AMENDED COMMENT ON HELS Ref: MHL-M-2022-473 ON THE 17.08.22	01	DB	20.09.02
PROPER VISIBILITY AT ENTRANCE/EXIT PROVIDED	02	DB	06.02.23
RE COMPUTATION & SHOWING PROPOSED REALIGNMENT OF PUBLIC ROAD AS PER SKIA	03	DB	14.02.23
PLAN AMENDED AS PER RAD - (Radius 6m)			

PLAN

SHOWING PROPOSED SUBDIVISION OF LAND FOR AGRICULTURAL PURPOSES INTO 11 LOTS SITUATED IN THE DISTRICT OF GRAND PORT PLACE CALLED " LES BAMBOUS ".

Note : THE SAID PORTION OF LAND BEING LOT No.1, OF AN ORIGINAL EXTENT OF 6A27P (26,464.85m²) HAS BEEN FOUND TO BE AFTER SURVEY OF A TOTAL EXTENT OF 2.5836ha or 6A12P, AFTER DEDUCTION OF A COMMON ROAD CROSSING THE PORTION OF LAND. FROM THIS EXTENT OF 2.5836ha or 6A12P, AN EXTENT OF 2.4949ha or 5A91P, IS BEING EXCISED INTO 11 LOTS MADE UP OF TWO BLOCKS (i) BLOCK A - 1.5842ha & (ii) Block B - 0.9107ha, AND THE REMAINING EXTENT IS BEING LEFT FOR THE PROPOSED REALIGNMENT OF FLACQ - MAHEBOURG ROAD B.28 (as per plan issued by the Road Development Authority bearing Ref. Drg. No.SV/22/11/LY/06 dated NOV 2022)

THE 11 LOTS NUMBERED 1 TO 11 OF AN EXTENT OF 2.3693ha, THE STRIP OF LAND OF AN IRREGULAR WIDTH LEFT FOR THE WIDENING OF THE COMMON ROADS TO 4.00m (Tinted Yellow), THE EXTENT OCCUPIED BY THE EXISTING ESTATE ROADS, THE EXTENT OCCUPIED BY THE EARTH DRAIN AND THE FEEDER FORM TOGETHER A TOTAL EXTENT OF 2.4949ha or 5A91P (Edged Red), BELONGING TO

Heirs Mr AUGUSTIN HENRI PIERRE EYNAUD,

AS PER TITLE DEED TRANSCRIBED IN VOLUME T.V 1725 No.101.

N.B : ALL INTERNAL ESTATE ROADS WILL BE CANCELLED AS LABELLED ON PLAN.

LOTS Nos. 7, 8 & 11 WILL NOT HAVE DIRECT VEHICULAR ACCESS ONTO "B.28".

Govinda S. NAIDOO
 LAND SURVEYOR

Govinda S. Naidoo
 Land Surveyor

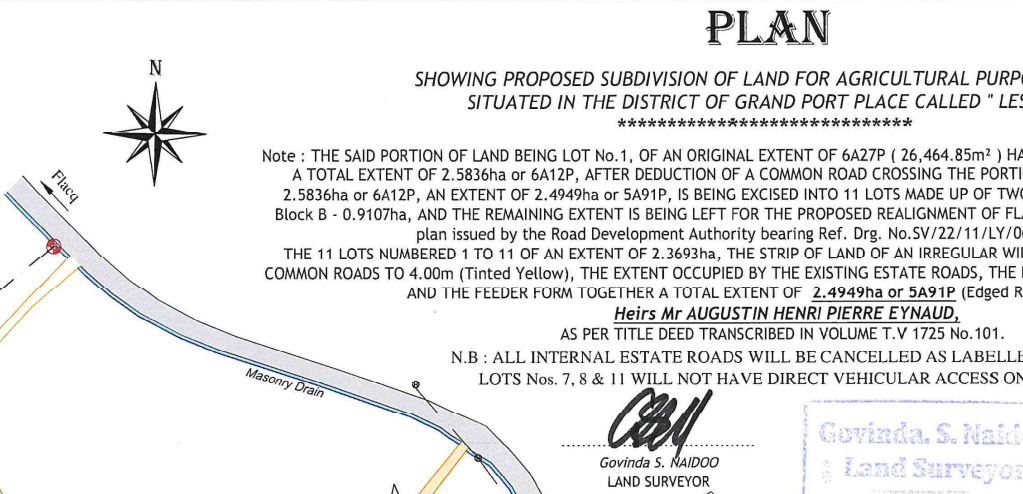
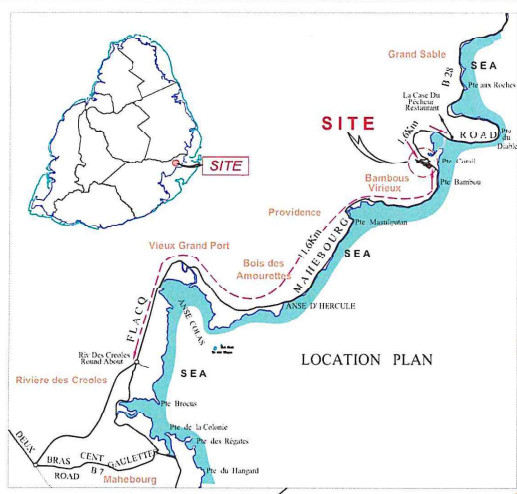

PROPOSED ACQUISITION LIMITS BASED ON

	LGM 2012	LE POUCE
PT 1	270709.8894mE, 342581.7773mN	1024441.148mE, 983985.872mN
PT 2	270720.9162mE, 342456.436mN	1024452.144mE, 983880.529mN
PT 3	270726.3957mE, 342441.2794mN	1024457.619mE, 983865.371mN
PT 4	270730.089mE, 342436.9004mN	1024461.311mE, 983860.991mN
PT 5	270736.0608mE, 342430.9871mN	1024467.281mE, 983855.076mN
PT 6	270748.7594mE, 342415.7706mN	1024479.975mE, 983839.856mN
PT 7	270786.5048mE, 342381.8661mN	1024517.710mE, 983805.941mN
PT 8	270824.3708mE, 342349.1936mN	1024555.566mE, 983773.258mN

Mr Alain Christophe Noel
 T.V 1725 No. 101.

Heirs of Mr Arjoon Ramdooce and others
 5A45P- 445/545
 T.V 1864 No. 19 and T.V 4760 No. 12

and

Heirs of Mrs Soobanteo Gungadeen and others
 5A45P- 100/545
 T.V 1864 No. 19, TV202009/000422 and TV202104/000798

Heirs Mr AUGUSTIN HENRI PIERRE EYNAUD
 Surplus of 6A27P
 T.V 1725 No. 101.

Mr Surendr Sharma Roopun and Other
 42563.84 m²
 T.V 8269 No. 44.

Block A
 1.5842ha-3A75P

Block B
 0.9107ha-2A16P

TERRAGRI LTD (NOVATERRA)
 Beau Plan Business Park - Beau Plan
 Pamplemousses 21001
 Republic of Mauritius
 Tel: 204 0808 Fax: 243 6151
 Vat No: 2000 1814 - BRN: CO700 1179

CENTROID (UTM-40S)
 579530mE , 7750313mN

Survey Method: RTK GPS (Trimble R1D)
 Control Point Used: GDS 1st
 Coordinates Control: 22420.50mE, 343159.36mN

TRAVERSE STATION BASED ON LGM 2012

Stn	X	Y	Z (m)
Stn 1	270564.11mE	342489.89mN	-

BOUNDARY COORDINATES BASED ON LGM 2012 (Northing mN , Easting mE)

C1	270784.545mE, 342383.625mN
C2	270736.677mE, 342332.262mN
C3	270619.359mE, 342406.001mN
C4	270728.963mE, 342438.235mN
C5	270725.496mE, 342443.766mN
C6	270603.993mE, 342414.478mN
C7	270437.759mE, 342503.032mN
C8	270433.876mE, 342545.559mN
C9	270513.607mE, 342536.455mN
C10	270720.101mE, 342464.218mN

Tropical Red Ltd
 20297.91m²
 TV201711/001915

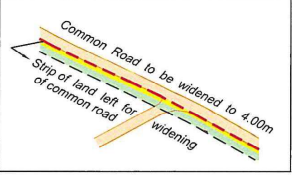
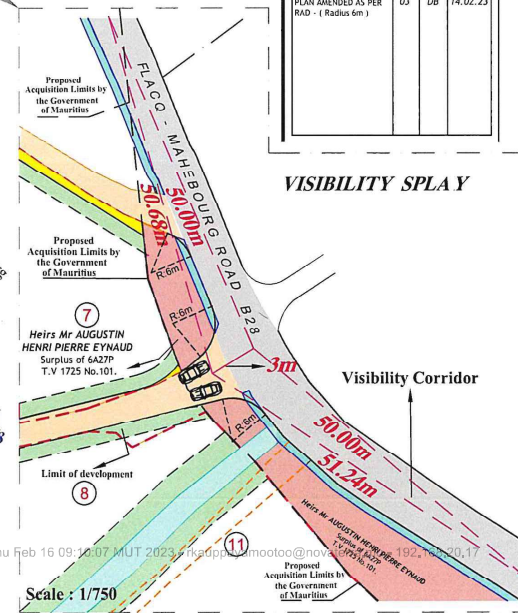

- Stn
- Limit of development
- Electricity Post
- Elec Post - High tension
- Telephone Post
- Sign Post
- Iron Peg
- Overhead High Tension Line