

REPUBLIQUE DE MAURICE
2020

PROJET DE EXCISION EN 88 LOTS
MORCELLEMENT AGRICOLES

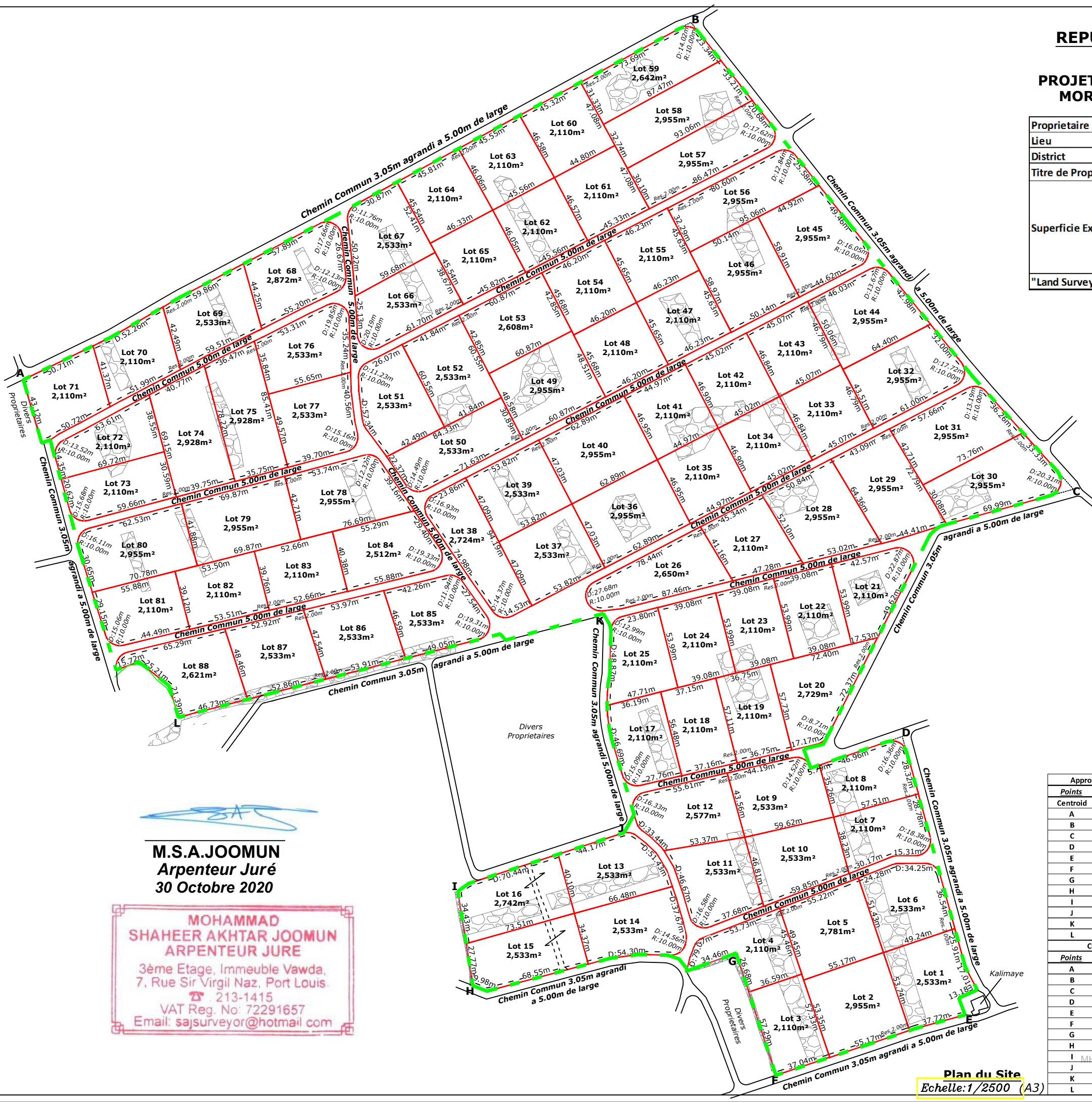

Propriétaire	Compagnie 'ALTEO AGRIL LTD'
Lieu	Clemencia
District	Flacq
Titre de Propriete	TV. 522 No.312, Chapitre Cinquième
Superficie Excision	232,392.00m ² formant partie du surplus de quatre portions de terrain contiguës de la contenance originaire de 770 A 18¼ Ps aussi connu sous la dénomination de 'CLEMENCIA'
"Land Surveyor"	M.S.A.Joomun



Coordinate System	Survey Method
Grid :LGM2012 Datum :GDM2008 Ellipsoid :WGS84 Projection :Lambert Conformal Conic Two Parallel Latitude of Origin:20° 16' 31.85868" S Central Meridian :57° 33' 52.40384" E False Coordinates of Origin :350000.00mE Scale Factor at Parallels :1.00000	Control :GPS131- Clemencia Base :Sokkia GPS (GRX2 Model)

Lot No	Superficie		Lot No	Superficie	
	m ²	Perches		m ²	Perches
1	2,533	60.0	45	2,955	70.0
2	2,955	70.0	46	2,955	70.0
3	2,110	50.0	47	2,110	50.0
4	2,110	50.0	48	2,110	50.0
5	2,781	65.9	49	2,955	70.0
6	2,533	60.0	50	2,533	60.0
7	2,110	50.0	51	2,533	60.0
8	2,110	50.0	52	2,533	60.0
9	2,533	60.0	53	2,608	61.8
10	2,533	60.0	54	2,110	50.0
11	2,533	60.0	55	2,110	50.0
12	2,577	61.1	56	2,955	70.0
13	2,533	60.0	57	2,955	70.0
14	2,533	60.0	58	2,955	70.0
15	2,533	60.0	59	2,642	62.6
16	2,742	65.0	60	2,110	50.0
17	2,110	50.0	61	2,110	50.0
18	2,110	50.0	62	2,110	50.0
19	2,110	50.0	63	2,110	50.0
20	2,729	64.7	64	2,110	50.0
21	2,110	50.0	65	2,110	50.0
22	2,110	50.0	66	2,533	60.0
23	2,110	50.0	67	2,533	60.0
24	2,110	50.0	68	2,872	68.0
25	2,110	50.0	69	2,533	60.0
26	2,650	62.8	70	2,110	50.0
27	2,110	50.0	71	2,110	50.0
28	2,955	70.0	72	2,110	50.0
29	2,955	70.0	73	2,110	50.0
30	2,955	70.0	74	2,928	69.4
31	2,955	70.0	75	2,928	69.4
32	2,955	70.0	76	2,533	60.0
33	2,110	50.0	77	2,533	60.0
34	2,110	50.0	78	2,955	70.0
35	2,110	50.0	79	2,955	70.0
36	2,955	70.0	80	2,955	70.0
37	2,533	60.0	81	2,110	50.0
38	2,724	64.5	82	2,110	50.0
39	2,533	60.0	83	2,110	50.0
40	2,955	70.0	84	2,512	59.5
41	2,110	50.0	85	2,533	60.0
42	2,110	50.0	86	2,533	60.0
43	2,110	50.0	87	2,533	60.0
44	2,955	70.0	88	2,621	62.1
Total			217,657	5,156.7	

Approx. Coordinates MGM 2008		
Points	Eastings(m)	Northings(m)
Centroid	571,514.882	7,759,774.450
A	571,156.040	7,759,855.703
B	571,592.763	7,760,089.339
C	571,843.057	7,759,784.048
D	571,731.070	7,759,622.397
E	571,772.113	7,759,440.348
F	571,648.364	7,759,400.890
G	571,622.309	7,759,480.717
H	571,450.160	7,759,459.556
I	571,440.318	7,759,521.022
J	571,549.062	7,759,559.493
K	571,535.530	7,759,702.749
L	571,257.455	7,759,634.998

Coordinates LGM 2012		
Points	Eastings(m)	Northings(m)
A	262,202.533	351,972.620
B	262,639.256	352,206.256
C	262,889.549	351,900.965
D	262,777.563	351,739.314
E	262,818.606	351,557.265
F	262,694.857	351,517.807
G	262,668.802	351,597.634
H	262,496.573	351,576.504
I	262,486.811	351,637.939
J	262,595.555	351,676.410
K	262,582.023	351,819.666
L	262,303.947	351,751.915

M.S.A.JOOMUN
Arpenteur Juré
30 Octobre 2020

MOHAMMAD
SHAHEER AKHTAR JOOMUN
ARPEN TEUR JURE
3ème Etage, Immeuble Vawda,
7, Rue Sir Virgil Naz, Port Louis.
T: 213-1415
VAT Reg. No: 72291657
Email: sajsurveyor@hotmail.com

Plan du Site
Echelle: 1/2500 (A3)