

**Company:** \_\_\_\_\_ **Date:** \_\_\_\_\_

**Contact:** \_\_\_\_\_ **Job name:** \_\_\_\_\_

**Address:** \_\_\_\_\_ **Email:** \_\_\_\_\_

**City:** \_\_\_\_\_ **State:** \_\_\_\_\_ **Zip:** \_\_\_\_\_ **PO#:** \_\_\_\_\_ **AG Salesperson:** \_\_\_\_\_

**Dealer Delivery:** No Yes **Job Site Delivery:** No Yes **Distance From Coast:** \_\_\_\_\_

**Net Frame Desired:** \_\_\_\_\_ (Recommended 1/2" top, 1/2" left, and 1/2" right spaces between frame and opening)

**Configuration (from exterior):** \_\_\_\_\_ (ex. 3L1R)

**Swing:** Outswing Inswing (Up-charge applies) (See Warranty Details)

**Material:** Clad/Wood Wood/Wood (PLEASE NOTE: All wood/wood doors must meet warranty site condition requirements)

**Wood species:** Paint-grade Pine Stain-grade Pine Vertical Grain Douglas Fir

Hand-Matched Vertical Grain Douglas Fir Walnut Clear Alder Knotty Alder African Mahogany

Sipo Mahogany Genuine Mahogany Cherry White Oak: ( Flat grain Quarter Sawn Rift Sawn)

Red Oak Accoya Wood: (Wood/Wood - 5 Year Warranty - Paint or Stain) Bass Wood: (Clad/wood only - Paint or Stain)

**Exterior Clad Color:** Carbon Black Espresso Brown Sandcastle Tan Linen White Clear Anodized

Custom Match: \_\_\_\_\_ (Up-charge applies)

**Retractable Screen** (min. 8 1/2" jamb)(max size 32' x 10'6") (Up-charge applies) **Extrusion color:** Black White

**Screen Pocket:** No Yes (Up-charge applies) **Door Panel Thickness:** 2 1/4"

**Type of Dual Glaze Cardinal Glass:** LoE 366 w/Argon (Standard) LoE 452 w/Argon 272 w/Argon

Other: \_\_\_\_\_ (Up-charge applies) Add i89 coating (Up-charge applies)

Energy Performance LoE 366 with Argon: Slimline .29/.21 | Euro .30/.19 | Traditional .31/.17 (.28/.16 with i89 coating)

**Lite Configuration:** SDL: 5/8" 7/8" 1 1/8" TDL: 1 1/2"

**SDL Shapes:** Ovolo Bevel Square

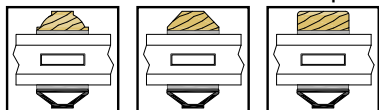

**Sticking/Stops:** Ovolo Bevel Square

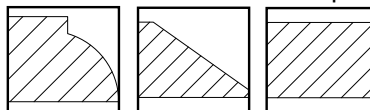

Draw lite configuration here

**Spacer Color:** Black Mill **Weather Strip Color:** Bronze White

**Stiles and Rails:** **NEW** Slimline: 2 1/2" Top rail/bottom rail/stiles & 3-7/16" lock rail Euro: 3-7/16" Top rail/bottom rail/stiles

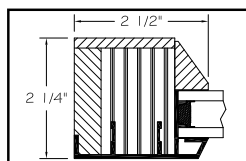

Slimline

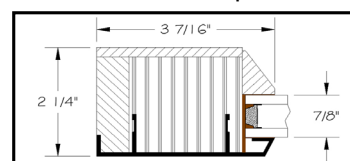

Euro

Traditional: 4 3/4" Top rail/stiles

Bottom rail: 7" or 4 3/4"

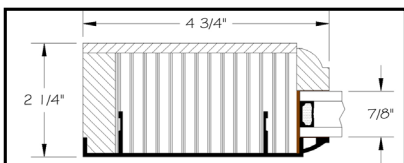

Traditional

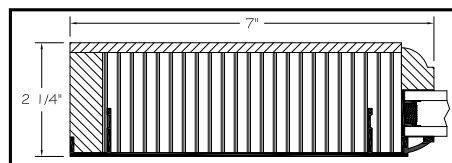

Traditional

**Sill Choice:**

Rounded

Energy Solutions

Ultra Guide

ADA Ultra Guide

Squared

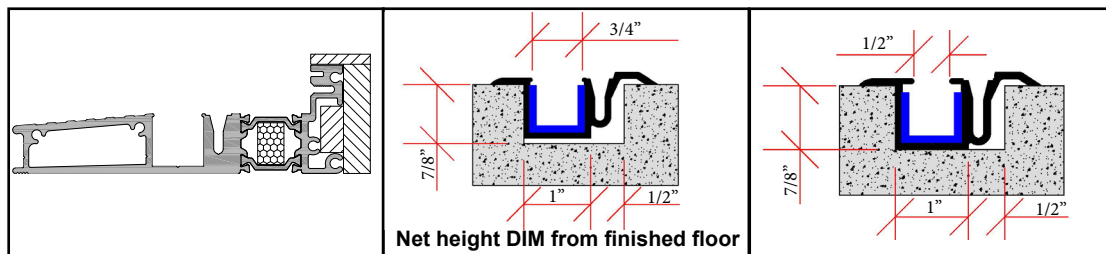

**Head Track Color:** Bronze Mill      **Sill Color:** Bronze Anodized Clear Anodized

**Hinge Color:** Bronze Stainless Steel      **Shoot-Bolt Color:** Bronze Brushed Chrome Black

**Interior/Exterior Casing:** Contact Office (Up-charge applies)

(PLEASE NOTE: Sill pans, nail fins, and other waterproofing measures are required for proper installation of all products)

**Flashing Fin:** No Yes      1 1/2" - Standard 7/8" Setback

**Handle Set Lock:** Exterior Key OR No Key (Up-charge applies)

**Handle Set Style:** Verona Dallas

**Finish:** Rustic Umber Matte Black Satin Nickel (Resista Finish) White (Verona only)

**Special order:** (\*Up-charge applies) Atlanta\* Rodos\* Munchen\* New Orleans\* Toronto\*

**Finish:** Rustic Umber (not available for Atlanta) Matte Black Satin Nickel (Resista Finish)

(PLEASE NOTE: Prefinish/paint color option MUST be determined by time of order)

**\*Prime:** No Yes (Up-charge applies)

**\*Paint:** No Yes Custom color\*: \_\_\_\_\_ (Up-charge applies)

**\*Prefinished Stain:** No Yes Standard color: \_\_\_\_\_

Custom color\*: \_\_\_\_\_ (Up-charge applies)

\*Special order which may delay lead time by 2 weeks

**NOTES:** Please add any special instructions here.

---



---



---



---



---