

STANDARD SLIDER QUOTE/ORDER FORM - PAGE 1



Company: _____

Date: _____

Contact: _____

Job name: _____

Address: _____

Email: _____

City: _____ State: _____ Zip: _____

PO#: _____ AG Salesperson: _____

Non-Pocketing Configuration: Unit Configuration (from exterior) X = Operable O = Fixed

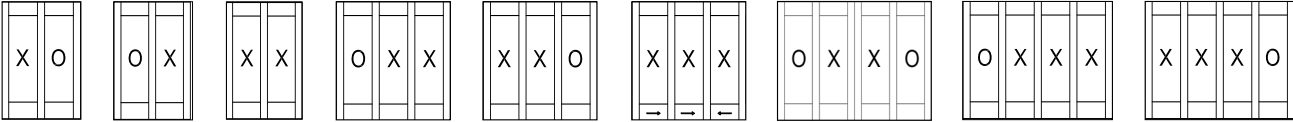

Skeletal Pocketing Configuration: Unit Configuration (from exterior) X = Operable P = Pocketing

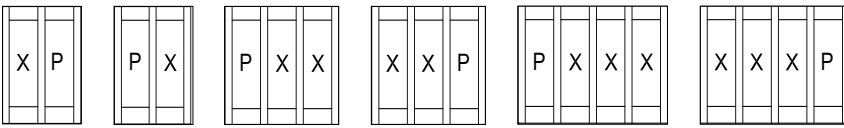

Active Panel: Left Right **90 Degree Corner:** No Yes

Draw configuration here

Material: Clad/Wood Wood/Wood (PLEASE NOTE: All wood/wood doors must meet warranty site condition requirements)

Wood Species: Paint-grade Pine Vertical Grain Douglas Fir Hand-Matched Vertical Grain Douglas Fir

Stain-grade Pine Walnut Clear Alder Knotty Alder African Mahogany Sipo Mahogany

Genuine Mahogany Cherry White Oak: (Flat grain Quarter Sawn Rift Sawn) Red Oak

Accoya Wood: (Wood/Wood - 5 Year Warranty - Paint or Stain) Bass Wood: (Clad/wood only - Paint or Stain)

Exterior Clad Color: Carbon Black Espresso Brown Sandcastle Tan Linen White Clear Anodized

Custom Clad Color Match: _____ (Up-charge applies)

Retractable Screen (min. 8 1/2" jamb)(max size 32' x 10'6") (Up-charge applies) **Extrusion color:** Black White

Screen Pocket: No Yes (Up-charge applies)

Net Frame Size: _____ (Recommended 1/2" top, 1/2" left, and 1/2" right spaces between frame and opening)

Type of Dual Glaze Cardinal Glass: LoE 366 w/Argon (Standard) LoE 452 w/Argon 272 w/Argon

Other: _____ (Up-charge applies) Add i89 coating (Up-charge applies)

Energy Performance LoE 366 with Argon: Euro .30/.21 | Traditional .30/.18

Lite Configuration: SDL: 1 1/8" 7/8" 5/8" TDL: 1-1/2"

SDL Shapes: Ovolo Bevel Square **Sticking/Stops:** Ovolo Bevel Square



Spacer Color: Black Mill

Weather Strip Color: Bronze White

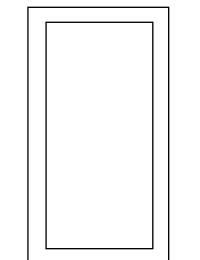

Draw lite configuration here

Breather Tubes: (Elevation above 300ft)

Stiles and Rails: **NEW** Slimline: 2 1/2" Top rail/bottom rail/stiles & 3-7/16" lock rail

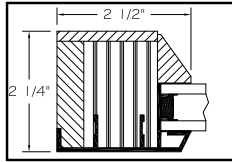

Slimline

Euro: 3 7/16" Top rail/stiles/bottom rail

OR Traditional: 4 3/4" Top rail/stiles Bottom rail: 7" or 4 3/4"

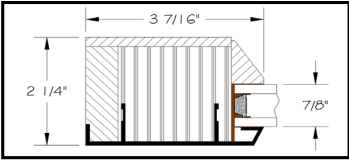

Euro

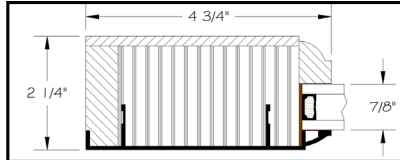

Traditional

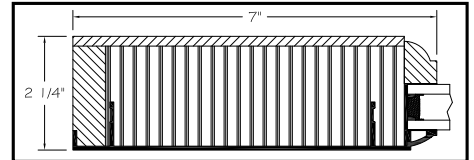

Traditional

Sill choice:

Stainless steel recessed (Up-charge applies)

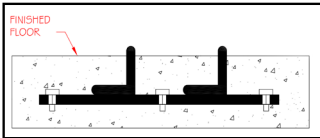

Low profile aluminum Bronze

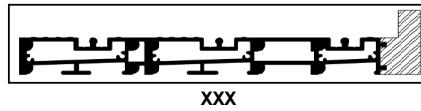

Clear Anodized

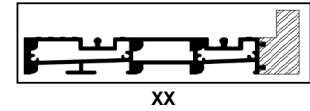

Interior/Exterior Casing: Contact office (Up-charge applies)

(PLEASE NOTE: SILL PANS, NAIL FINES AND OTHER WATERPROOFING MEASURES ARE REQUIRED FOR PROPER INSTALLATION OF ALL PRODUCTS)

Flashing Fin: No Yes 1 1/2" - Standard 7/8" setback

(PLEASE NOTE: NO FLASHING FIN ON POCKET DOORS)

Handle Set Style:

Verona

Dallas (Up-charge applies)

- Finish: White Matte Black
Polished Brass (Restista Finish)
Polished Chrome
Satin Nickel
Oil Rubbed Bronze

- Finish: Satin Nickel Rustic Umber
Matte Black
One Piece Truth Flush Mount for Pocketing Systems
Finish: Satin Nickel Polished Chrome
Oil Rubbed Bronze

(PLEASE NOTE: Prefinish/paint color option MUST be determined by time of order)

*Prime: No Yes (Up-charge applies)

Paint: No Yes Custom color: _____ (Up-charge applies)

*Prefinished Stain: No Yes Standard color: _____

Custom color*: _____ (Up-charge applies)

*Special order which may delay lead time by 2 weeks

NOTES: Please add any special instructions here:
